

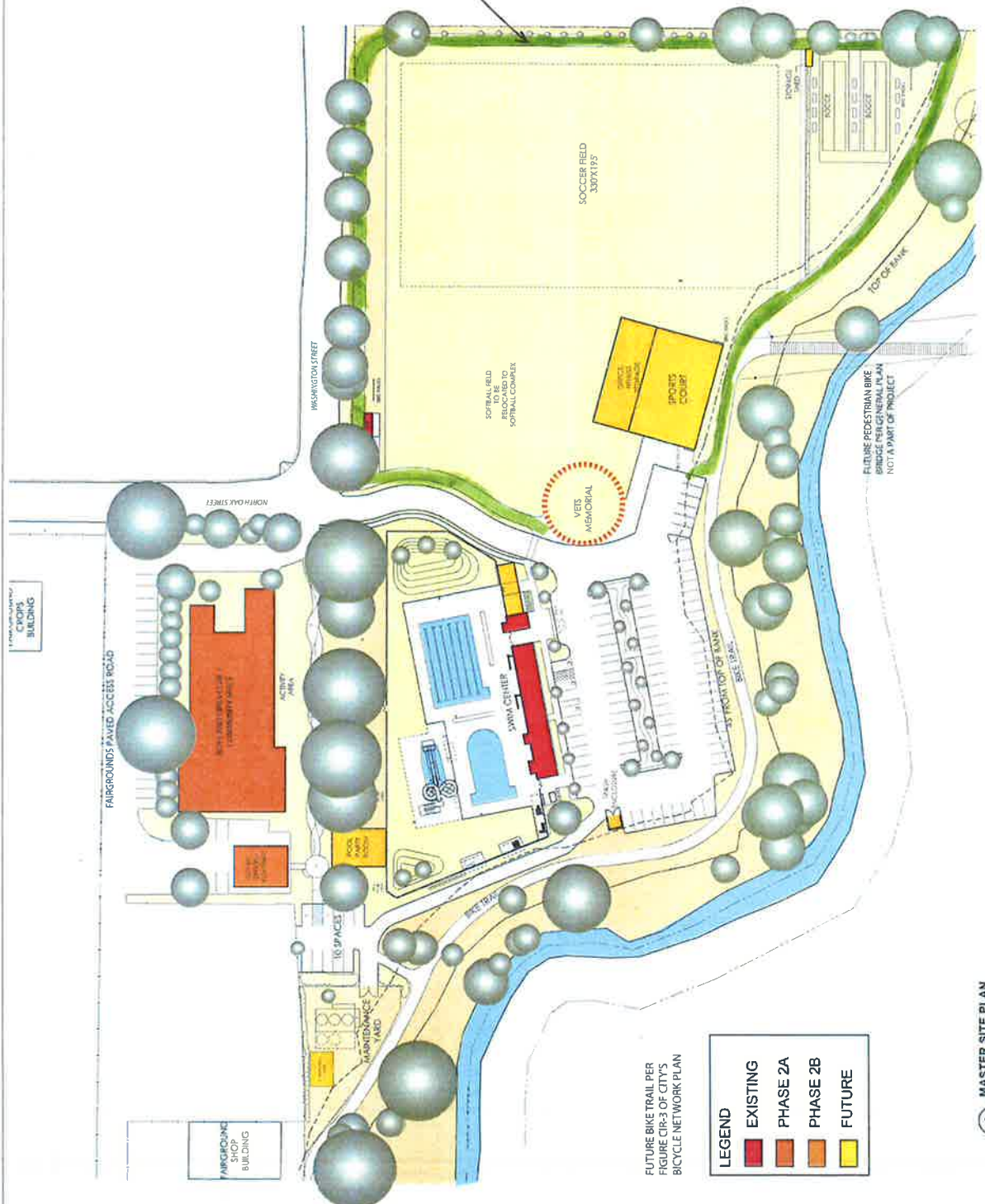

LOGGY COMMUNITY PARK  
 1745 WASHINGTON STREET  
 CALISTOGA CA 94515  
 CITY OF CALISTOGA  
 APN # 011-140-056 AND #011-10-009

12.15.20

MASTER PLAN



FUTURE BIKE TRAIL PER FIGURE CIR-3 OF CITY'S BICYCLE NETWORK PLAN

**LEGEND**

- EXISTING
- PHASE 2A
- PHASE 2B
- FUTURE

1 MASTER SITE PLAN  
 SCALE 1"=40'

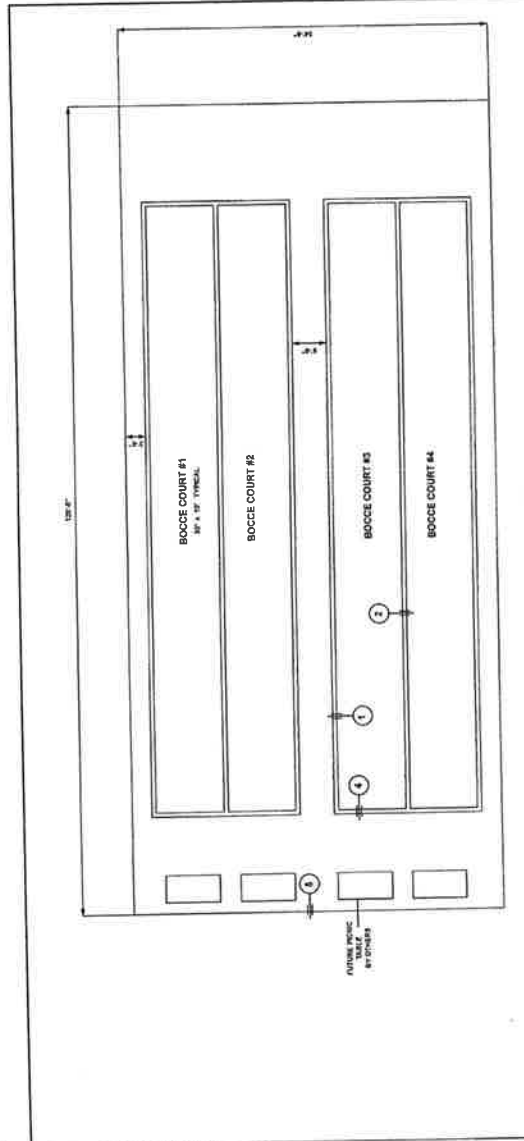

**BOCCIE COURT LAYOUT PLAN**  
 SCALE: 1/4" = 1'-0"  
 NORTH

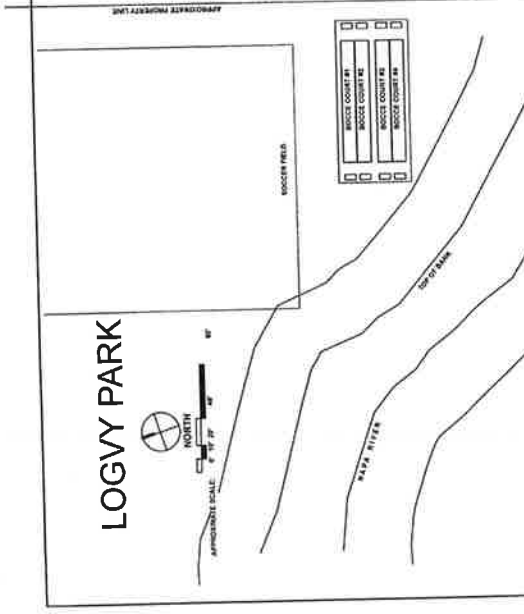

**SOUTHWEST CORNER - PARTIAL SITE PLAN**

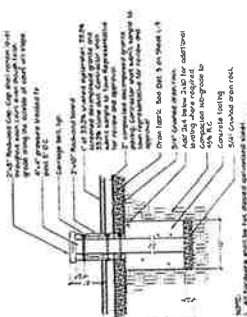

**1. BOCCIE COURT OUTER WALL**  
 NOT TO SCALE

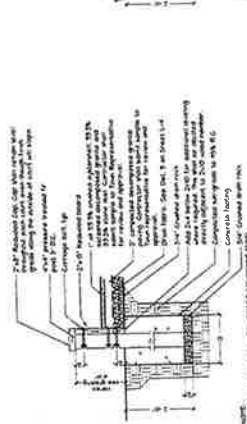

**2. BOCCIE COURT CENTER WALL**  
 NOT TO SCALE

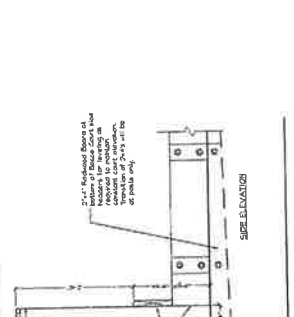

**3. BOCCIE COURT DRAINAGE PIPE**  
 NOT TO SCALE

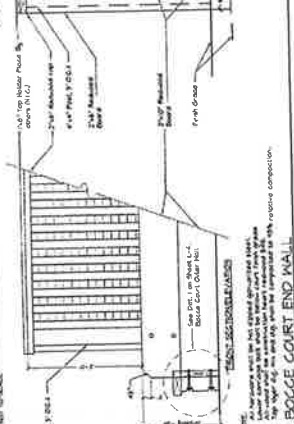

**4. BOCCIE COURT END WALL**  
 NOT TO SCALE

**5. D.G. PAVING**  
 NOT TO SCALE

**6. SAMPLE COURT DETAILS**



**DRAWING NOTICE**  
 THIS DRAWING IS THE PROPERTY OF AERION AND IS NOT TO BE REPRODUCED OR TRANSMITTED IN ANY FORM OR BY ANY MEANS, ELECTRONIC OR MECHANICAL, INCLUDING PHOTOCOPYING, RECORDING, OR BY ANY INFORMATION STORAGE AND RETRIEVAL SYSTEM, WITHOUT THE WRITTEN PERMISSION OF AERION. AERION SHALL NOT BE RESPONSIBLE FOR ANY ERRORS OR OMISSIONS IN THIS DRAWING. THE USER OF THIS DRAWING SHALL BE RESPONSIBLE FOR OBTAINING ALL NECESSARY PERMITS AND APPROVALS FROM THE APPROPRIATE AGENCIES. THE USER OF THIS DRAWING SHALL BE RESPONSIBLE FOR OBTAINING ALL NECESSARY PERMITS AND APPROVALS FROM THE APPROPRIATE AGENCIES.

**SITE INFORMATION**  
 MAP NO. 100-000  
 ADDRESS: 1000 MICHIGAN STREET  
 CANTON, CA 94503

**MAP OF TOPOGRAPHY**  
 LOGGY PARK  
 OF A PORTION OF THE LANDS OF  
 THE CITY OF CALISTOGA COUNTY OF NAPA STATE OF CALIFORNIA

**REVISIONS & ADDITIONS**

NO.	DATE	DESCRIPTION
1	07/15/2015	ISSUED FOR PERMITTING
2	07/15/2015	ISSUED FOR PERMITTING
3	07/15/2015	ISSUED FOR PERMITTING
4	07/15/2015	ISSUED FOR PERMITTING
5	07/15/2015	ISSUED FOR PERMITTING
6	07/15/2015	ISSUED FOR PERMITTING
7	07/15/2015	ISSUED FOR PERMITTING
8	07/15/2015	ISSUED FOR PERMITTING
9	07/15/2015	ISSUED FOR PERMITTING
10	07/15/2015	ISSUED FOR PERMITTING

**ALSIAN REFERENCES**  
 PROJECT NO. 100-000  
 DATE OF SURVEY: 07/15/2015  
 SURVEY NUMBER: 100-000-001  
 SCALE: 1" = 20' (HORIZONTAL)  
 1" = 40' (VERTICAL)

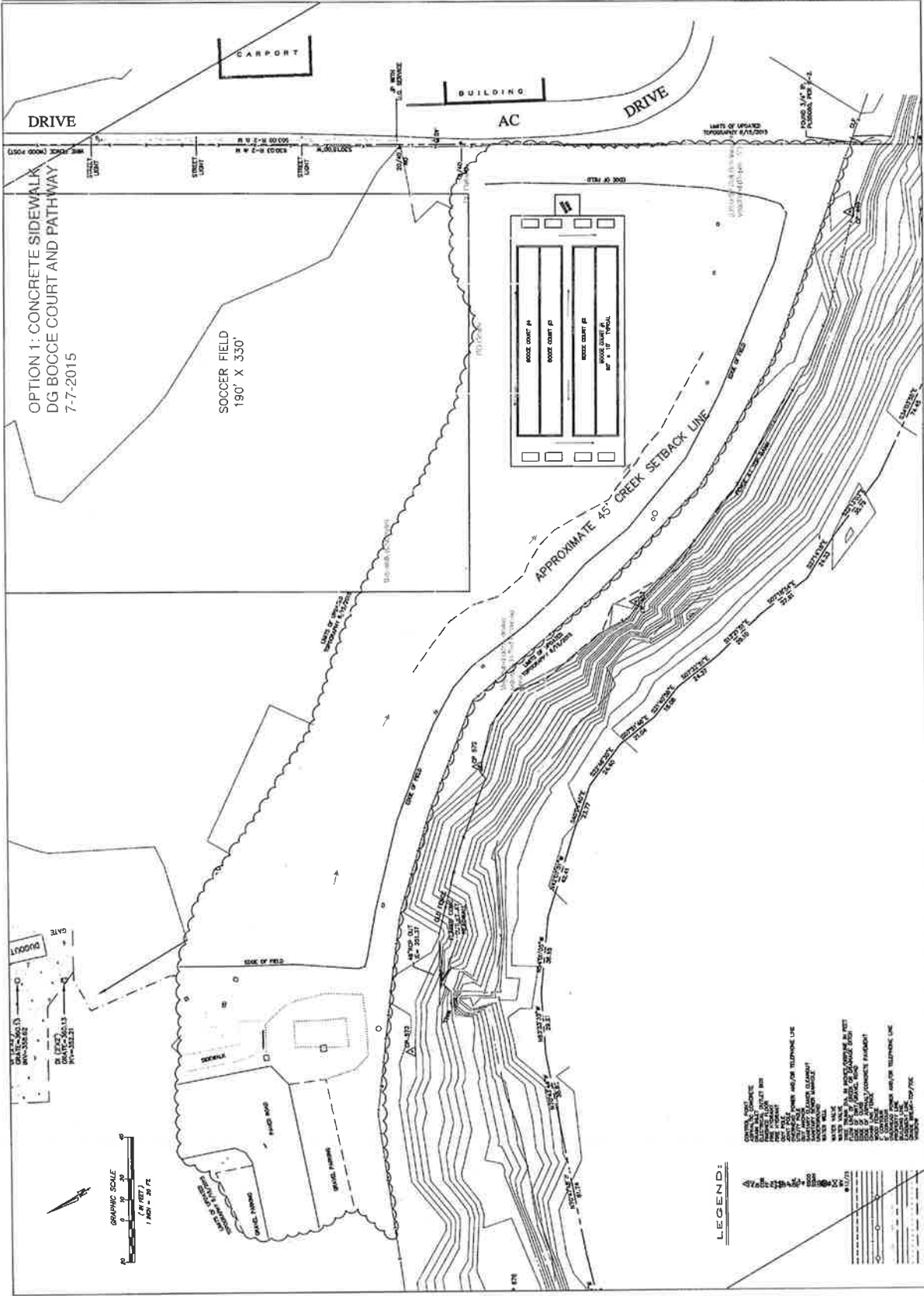

OPTION 1: CONCRETE SIDEWALK  
 DG BOCCO COURT AND PATHWAY  
 7-7-2015

SOCCER FIELD  
 190' X 330'



**LEGEND:**

[Symbol]	CONTOUR
[Symbol]	BOUNDARY
[Symbol]	PROPERTY LINE
[Symbol]	SETBACK LINE
[Symbol]	WATER
[Symbol]	ROAD
[Symbol]	DRIVE
[Symbol]	STREET LIGHT
[Symbol]	UTILITY
[Symbol]	CONCRETE
[Symbol]	ASPHALT
[Symbol]	GRAVEL
[Symbol]	SOIL
[Symbol]	ROCK
[Symbol]	WOOD
[Symbol]	PAVED
[Symbol]	UNPAVED
[Symbol]	CONCRETE
[Symbol]	ASPHALT
[Symbol]	GRAVEL
[Symbol]	SOIL
[Symbol]	ROCK
[Symbol]	WOOD
[Symbol]	PAVED
[Symbol]	UNPAVED





# TABLES



445-26 Shown in Argento

## TABLE 445 ▲

### Table w/Steel Strap Seats

445-13	42" Table, 3 Seat, Accessible, 330 lbs.	<b>\$2,515</b>
445-14	42" Table, 4 Seat, Steel Strap, 388 lbs.	<b>\$2,925</b>
445-15	42" Table, 5 Seat, Steel Strap, 469 lbs.	<b>\$3,550</b>
445-16	42" Table, 6 Seat, Steel Strap, 548 lbs.	<b>\$4,100</b>

### Table w/Steel Laser Cut Patterned Seats

445-23	42" Table, 3 Seat, Accessible, 277 lbs.	<b>\$2,545</b>
445-24	42" Table, 4 Seat, Stl. Patterned, 316 lbs.	<b>\$2,800</b>
445-25	42" Table, 5 Seat, Stl. Patterned, 381 lbs.	<b>\$3,490</b>
445-26	42" Table, 6 Seat, Stl. Patterned, 440 lbs.	<b>\$4,100</b>

### Table w/lpe Seats

445-33I	42" Table, 3 Seat, Accessible, 292 lbs	<b>\$2,260</b>
445-34I	42" Table, 4 Seat, 2" x 3" lpe, 337 lbs.	<b>\$2,590</b>
445-35I	42" Table, 5 Seat, 2" x 3" lpe, 406 lbs.	<b>\$3,150</b>
445-36I	42" Table, 6 Seat, 2" x 3" lpe, 471 lbs.	<b>\$3,690</b>



Steel Strap Seat



Wood Seat

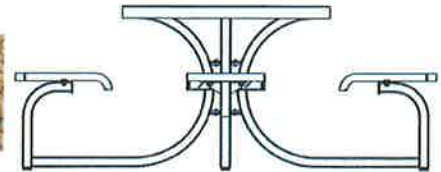

### Table w/Douglas Fir Seats

445-33D	42" Table, 3 Seat, Accessible, 271 lbs.	<b>\$2,130</b>
445-34D	42" Table, 4 Seat, 2" x 3", 310 lbs.	<b>\$2,420</b>
445-35D	42" Table, 5 Seat, 2" x 3", 372 lbs.	<b>\$2,900</b>
445-36D	42" Table, 6 Seat, 2" x 3", 430 lbs.	<b>\$3,400</b>

### Table w/Recycled Plastic Seats

445-33PL	42" Table, 3 Seat, Accessible, 276 lbs.	<b>\$2,085</b>
445-34PL	42" Table, 4 Seat, 2" x 3" Recy. PL., 315 lbs.	<b>\$2,370</b>
445-35PL	42" Table, 5 Seat, 2" x 3" Recy. PL., 379 lbs.	<b>\$2,890</b>
445-36PL	42" Table, 6 Seat, 2" x 3" Recy. PL., 438 lbs.	<b>\$3,300</b>

## TABLE 198 >>

198-40PL	Table, 4 Seat, 183 lbs.	<b>\$1,800</b>
198-60PL	Table, 6 Seat, 272 lbs.	<b>\$2,180</b>
198-80PL	Table, 8 Seat, 355 lbs.	<b>\$2,470</b>

- Both ends of the 198-60PL (shown) are wheelchair accessible
- Great for high occupancy areas

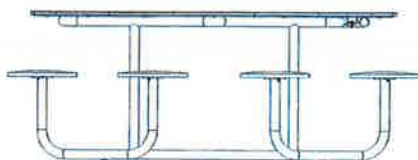

Shown w/Black finish/Grey plastic





125-30 Shown in Black  
Shown with S-2 option covers

## BIKE RACK 125/130 ▲

		PC	HDGalv		PC	HDGalv	
125-20	2-7/8" O.D., Holds 5 bikes, 97 lbs.	\$310	\$405	130-20	2-3/8" O.D., Holds 5 bikes, 62 lbs.	\$255	\$330
125-30	2-7/8" O.D., Holds 7 bikes, 134 lbs.	\$450	\$565	130-30	2-3/8" O.D., Holds 7 bikes, 84 lbs.	\$335	\$425
125-40	2-7/8" O.D., Holds 9 bikes, 170 lbs.	\$590	\$735	130-40	2-3/8" O.D., Holds 9 bikes, 107 lbs.	\$425	\$555
125-50	2-7/8" O.D., Holds 11 bikes, 206 lbs.	\$790	\$1,070	130-50	2-3/8" O.D., Holds 11 bikes, 129 lbs.	\$520	\$665
125-60	2-7/8" O.D., Holds 13 bikes, 256 lbs.	\$1,125	\$1,340	130-60	2-3/8" O.D., Holds 13 bikes, 161 lbs.	\$615	\$830

• Mounting hardware included

Support Options: S-1, and S-2

\* Add \$100 to unit price for support option S-2.

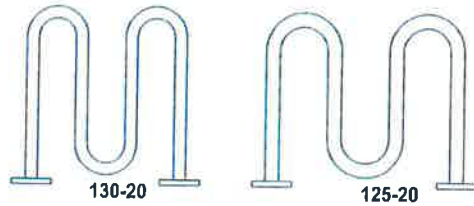

## BIKE RACK 81/82 ▼

Single-Side Entry Bike Rack

81-10 10' long, 9 openings, 163 lbs. \$520

81-50 5' long, 4 openings, 103 lbs. \$365

Dual-Side Entry Bike Rack

82-10 10' long, 18 openings, 191 lbs. \$620

82-50 5' long, 8 openings, 118 lbs. \$410

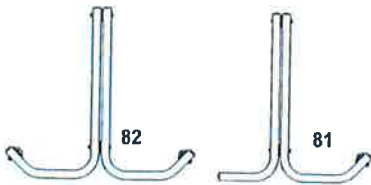

Shown in Galvanized

## BIKE RACK 188 ▼

188-05 41-1/4" long, 5 openings, 61 lbs. \$830

188-07 57-1/4" long, 7 openings, 70 lbs. \$870

188-09 73-1/4" long, 9 openings, 79 lbs. \$905

188-11 89-1/4" long, 11 openings, 89 lbs. \$925

188-12 105-1/4" long, 13 openings, 98 lbs. \$980

188-15 121-1/4" long, 15 openings, 107 lbs. \$1,025

Mounting hardware included

Support Options: S-1, and S-2\*

\* Add \$100 to unit price for support option S-2.



Shown in Black  
Shown with S-2 option covers





Shown in Green

### BENCH 190

190-60	6' long, 2 supports, 277 lbs.	\$1,085
190-80	8' long, 2 supports, 325 lbs.	\$1,225
	Add to unit price for center armrest	\$120

- Timeless design
- Flowing lines



Shown in Hunter Green

### RECEPTACLE 429

429-32-FTO	32-gallon All-Steel Receptacle, 191 lbs.	\$1,135
429-32-SO1	32-gallon All-Steel one side opening, 204 lbs.	\$1,210
429-32-SO2	32-gallon All-Steel two side openings, 203 lbs.	\$1,265
429-32-SO3	32-gallon All-Steel three side openings, 201 lbs.	\$1,325

- Hinged cover
- Top deposit or side deposit covers

Additional cover options on page 39



429-32-SO3

### PLANTER 431

431-00	All-Steel Planter, 86 lbs.	\$795
--------	----------------------------	-------

- Sturdy polyethylene liner
- Self watering liner option available



Shown in Hunter Green

### BENCH 191

191-60	6' long, 2 supports, 205 lbs.	\$795
191-80	8' long, 2 supports, 239 lbs.	\$865
	Add to unit price for center armrest	\$105

- Timeless design
- Natural lines



Shown in Hunter Green

# Logvy Park Improvements Cost Estimate

## Bocce Courts

Item	Quantity	Unit Price	Extension
Crushed Rock	50 CY	\$ 50	\$ 2,500
Decomposed Granite	27 CY	\$ 150	\$ 4,050
Oyster Shell Mix	12 CY	\$ 152	\$ 1,824
Bark Ground Cover	3000 SF	\$ 4	\$ 12,000
Filter Fabric	360 SF	\$ 1	\$ 180
4x4 Posts	180 LF	\$ 3	\$ 540
2x8 Redwood	640 LF	\$ 3	\$ 1,920
2x10 Redwood	810 LF	\$ 4	\$ 2,835
2x4	810 LF	\$ 1	\$ 608
Concrete - posts and table foundations	20 CY	\$ 138	\$ 2,760
Hardware	1 LS	\$ 750	\$ 750
Picnic Tables Style 198-80PL	6 EA	\$ 2,470	\$ 14,820
Bike Racks Style 188-15	2 EA	\$ 1,025	\$ 2,050
Trash/Recycable Receptacles Style 429-32-FTO	4 EA	\$ 1,135	\$ 4,540
Benches Style 190-80	4 EA	\$ 1,225	\$ 4,900
ADA Parking Stalls	2 EA	\$ 4,000	\$ 8,000
Kiosk	1 LS	\$ 350	\$ 350
Storage Shed	1 LS	\$ 1,000	\$ 1,000
ADA Signage	1 LS	\$ 150	\$ 150
Excavate Retention Basin	50 CY	\$ 20	\$ 1,000
Basin			
Hydroseed Basin	2000 SF	\$ 3	\$ 6,000
		<b>Subtotal Materials</b>	<b>\$ 72,777</b>
Labor	50% of Materials		\$ 36,388
		<b>Total Bocce Courts</b>	<b>\$ 109,165</b>

## 10'-Wide Perimeter Path (1,500 Lineal Feet)

Item	Quantity	Unit Price	Extension
12" Deep Excavation - Price includes constrained work areas	555.6 CY	\$ 60	\$ 33,333
8" Rock Ag Base	675.0 Tons	\$ 50	\$ 33,750
4" Concrete Path Way 10'	209.9 CY	\$ 180	\$ 37,778
3" Drainage Pipe	200 LF	\$ 2	\$ 400
		<b>Subtotal Materials</b>	<b>\$ 105,261</b>
Labor	50% of Materials		\$ 52,631
		<b>Total Path</b>	<b>\$ 157,892</b>
		<b>Total Improvements</b>	<b>\$ 267,056</b>

Construction Contingency @ 10%			\$	<b>26,706</b>	
Environmental Review	1 LS	\$	5,000	\$	5,000
Project Management @ 3%	1 LS	\$	8,012	\$	8,012
Project Inspection @ 4%	1 LS	\$	10,682	\$	10,682
Permits @ 2%	1 LS	\$	5,341	\$	5,341
				\$	<b>29,035</b>
				\$	<b>322,797</b>
Supplemental Funding					
				\$	7,000
				\$	5,000
				\$	30,000
				\$	<b>42,000</b>
				\$	<b>280,797</b>



June 15, 2016

Calistoga City Council  
1232 Washington Street  
Calistoga, CA 94515



**Re: 2016 Community Development Block Grant NOFA**

Dear Mayor Canning and Honorable Council Members:

The UpValley Family Centers is interested to submit a proposal for Community Development Block Grant (CDBG) funding for Public Service Activities as part of the City's CDBG grant application. We propose applying to offer up to three public services over a period of three years: Senior Services, Battered and Abused Spouses, and Subsistence Payments. Our total budget for these public services is estimated at \$90,000/year, or \$270,000 over three years.

**1. Battered and Abused Spouses - new service**

UpValley Family Centers currently provide immediate crisis intervention to battered and abused spouses, ensuring an immediate response so that the victim is safe. We propose offering new services to victims of domestic violence by providing longer-term case management that will support the victims with court system navigation, assistance in locating employment or job training, individualized consultations to develop parenting skills, and help in meeting other basic needs. We propose serving five low-income clients per month over several months, and up to 25 clients annually with these new services. Services would be provided at our office at 1705 Washington Street. No other similar services are being provided in Calistoga.

Demonstration of need: We have experienced a 100% increase in requests for services by battered and abused spouses over the past three years. In 2013-14 we assisted 11 clients with immediate crisis intervention; in 2014-15 we assisted 17 clients; in 2015-16 we assisted 22 clients. Unfortunately, beyond immediate crisis intervention, our ability to support victims to move towards longer term health and wellness is limited due to lack of resources. Our clients, the majority of whom speak Spanish as their primary language, report they have experienced significant confusion and frustration with legal and court processes related to permanent restraining orders, child custody and divorce. There are very limited free legal advocates or navigators available in Napa County and none are based in Calistoga; the majority of our clients cannot access such services in the needed timeframe which leaves them on their own to get through the process. If this service is not provided, Calistoga victims of domestic violence may be forced to remain in unsafe, unhealthy living situations. They are likely to experience higher stress levels over a prolonged period which impact their long-term health outcomes and the well-being of any children involved.

Funds requested for this service area: \$37,500/year or \$112,500 over three years.

**2. Senior Services - existing service to be increased**

UpValley Family Centers currently provides case management services for 20 seniors/month and serve approximately 200 low-income seniors annually. We propose serving 10 additional low-income Calistoga senior households per month with case management services, expanding

our capacity to reach seniors by 50%. We estimate serving up to 100 additional senior households per year and 300 households over three years with increased case management services focused on health, wellness and financial stability for low-income seniors. There are no other similar services available in Calistoga and transportation challenges make it difficult for seniors to get services outside of Calistoga. Services would be provided at our office at 1705 Washington Street.

Demonstration of need: According to the US Census Napa County's population of adults ages 65 and older was 20,400 in 2010 and 40% of the County's seniors are concentrated up valley, with a majority living in Calistoga. The Napa County senior population is expected to grow to 27,500 by 2020 (Napa County Health & Human Services). A 2014 report produced by Calistoga Affordable Housing indicates that Calistoga's Mobile Home Parks represent 24% of the city's housing (556 spaces) - three of those parks are dedicated to seniors. 39% of 94 park residents surveyed responded that increases in space rent caused them to make difficult changes their spending (food, bills etc.). For 19% of residents, Social Security is their only form of income. Household income for seniors living in the parks was documented as follows: 29% of residents have incomes classified as extremely low (30% AMI); 31% as very low (50% AMI); 22% as low (80% AMI) - totaling 82% of senior residents who could benefit from CDBG Senior Services offered by UVFC. If this service is not provided, greater numbers of senior households may not receive the resources they need to remain stable, healthy and in their homes.

Funds requested for this service area: \$40,000/year or \$120,000 over three years.

### 3. Subsistence Payments - existing service to be increased

UpValley Family Centers provide limited emergency assistance funds through donations to prevent financial hardship from leading to deeper crisis, such as homelessness. Our limited resources do not allow us to serve the demand. We propose this existing service to be increased so that we can provide up to 25 low-income households annually with subsistence payments that enable them to pay utility or rent bills when faced with financial hardship. Services would be provided at our office at 1705 Washington Street and at our office at 1500 Cedar Street in Calistoga. No other similar services are being provided in the community.

Demonstration of need: In 2015-16, UpValley Family Centers provided limited emergency assistance to 34 Calistoga low-income households in the amount of \$250 in one-time financial support to pay for utilities or a partial rent payment. It is a fraction of the help these and other households need. Approximately 15% of Calistoga's population lives in poverty (US Census). According to 2013-14 Calistoga's school accountability report card nearly 80% of Calistoga Elementary School students are economically disadvantaged. Availability of CDBG Subsistence Payments will have greater impact on a senior's or family's ability to stay in their home. If this service is not provided, more Calistoga households have a greater likelihood to have utility service interrupted, to go without food, or to fall into homelessness.

Funds requested for this service area: \$12,500/year or \$37,500 over three years.

Thank you for your consideration of our proposed services.

  
Jenny Ocon  
Executive Director

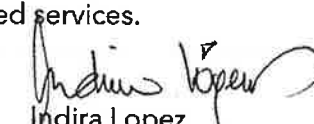
  
Indira Lopez  
Program Director